

12 Faro Close, Bromley

£1,750 pcm

AVAILABLE IMMEDIATELY • SECOND FLOOR FLAT • TWO DOUBLE BEDROOMS WITH FITTED WARDROBES • FITTED KITCHEN • VERY SHORT WALK TO CHISLEHURST STATION • DOUBLE GLAZING THROUGHOUT • ELECTRIC HEATING AND HOT WATER SYSTEM • STORAGE CUPBOARD AND ACCESS TO LOFT SPACE • FULLY TILED BATHROOM WITH WC, BASIN, AND BATH WITH SHOWER • INTEGRATED FRIDGE FREEZER, DISHWASHER, ELECTRIC OVEN & HOB AND A WASHING MACHINE



GROUND FLOOR
650 sq.ft. (60.4 sq.m.) approx.

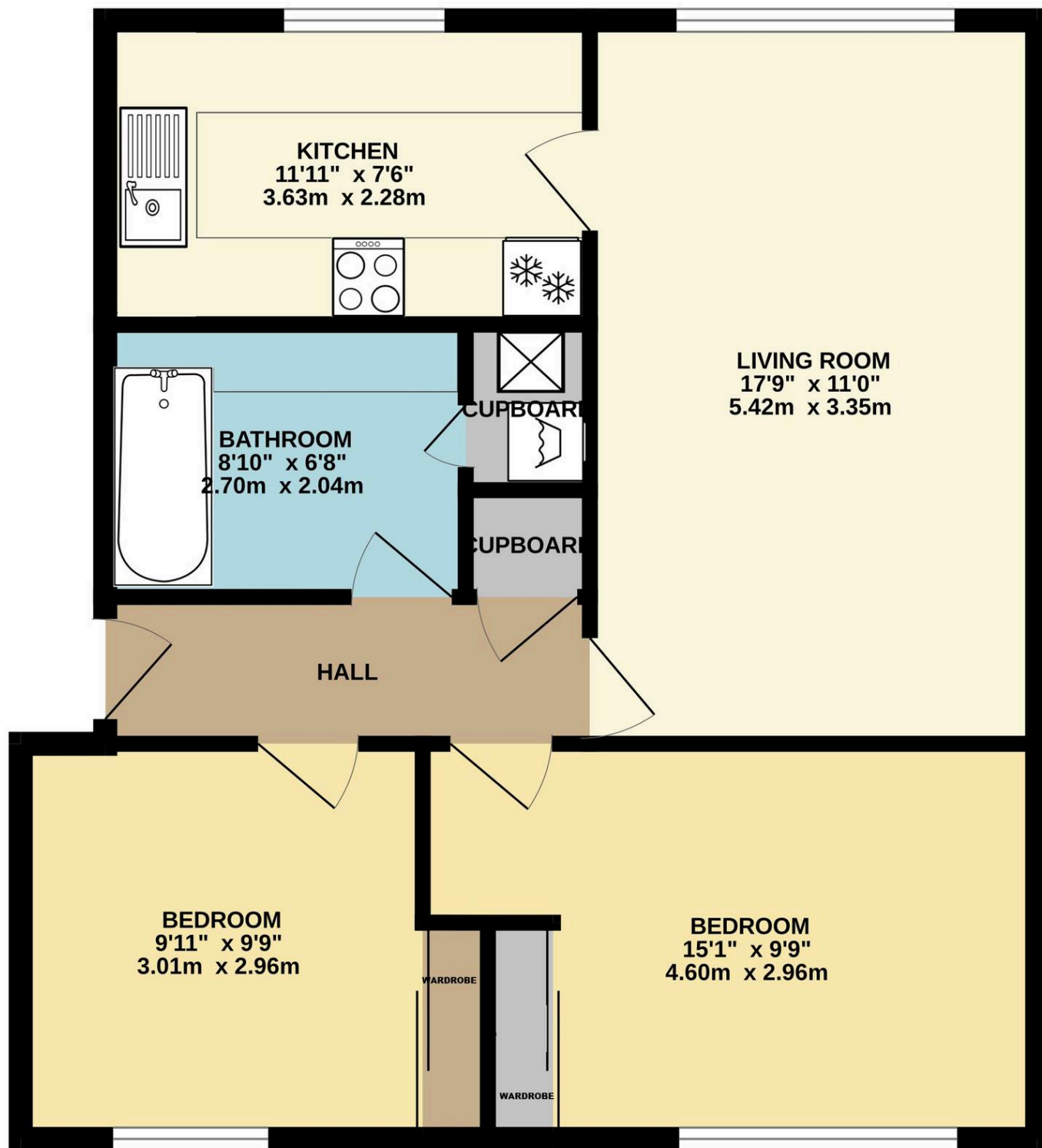

TOTAL FLOOR AREA : 650 sq.ft. (60.4 sq.m.) approx.

Whilst every attempt has been made to ensure the accuracy of the floorplan contained here, measurements of doors, windows, rooms and any other items are approximate and no responsibility is taken for any error, omission or mis-statement. This plan is for illustrative purposes only and should be used as such by any prospective purchaser. The services, systems and appliances shown have not been tested and no guarantee as to their operability or efficiency can be given.

Made with Metropix ©2026

From Chislehurst, go down Summer Hill and under the rail bridge by the station. Turn left into Coats Hill Road and then Faro Close is on the left past the telephone exchange building.