



62 Edgewood Drive, Orpington

£1,600 pcm

AVAILABLE IMMEDIATELY • GROUND FLOOR SPLIT LEVEL APARTMENT • TWO DOUBLE BEDROOMS • CLOSE TO GREEN STREET
GREEN HIGH STREET • 0.7 MILE WALK TO CHELSFIELD STATION • COMMUNAL GARDEN TO REAR

Holding Fee: £369.23 – Deposit: £1846.15

Annual Income Required: £48,000



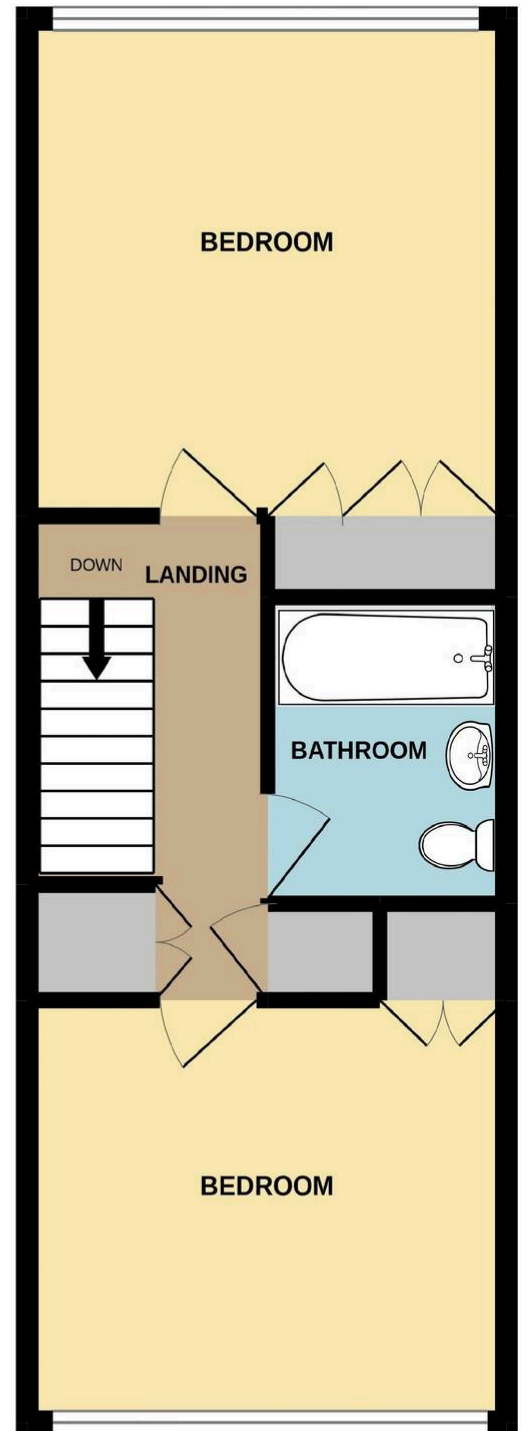
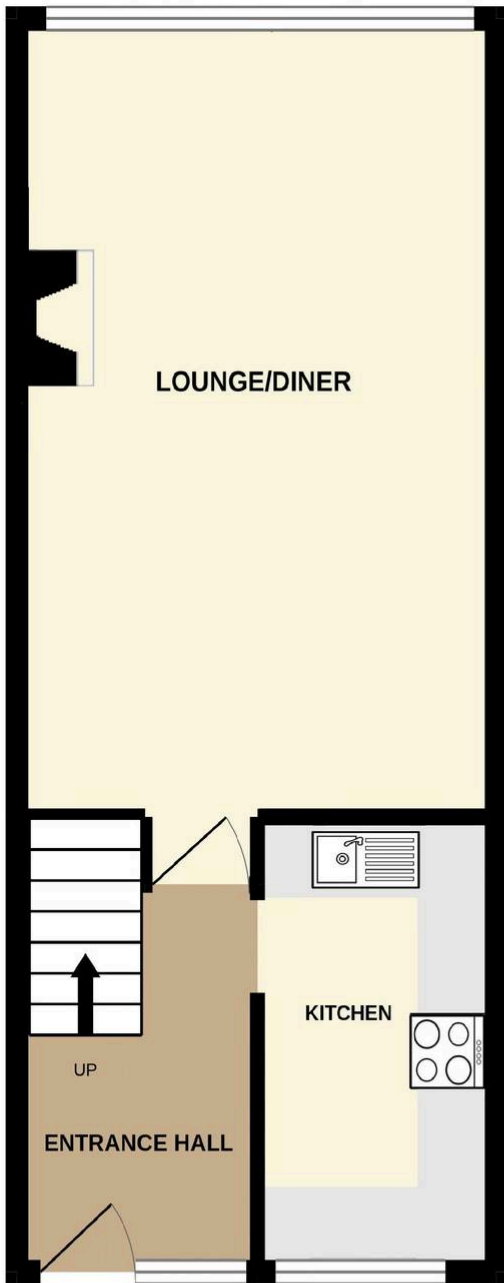

Whilst every attempt has been made to ensure the accuracy of the floorplan contained here, measurements of doors, windows, rooms and any other items are approximate and no responsibility is taken for any error, omission or mis-statement. This plan is for illustrative purposes only and should be used as such by any prospective purchaser. The services, systems and appliances shown have not been tested and no guarantee as to their operability or efficiency can be given.
Made with Metropix ©2022

You can include any text here. The text can be modified upon generating your brochure.