

47 York Rise, Orpington

£350,000 Freehold

CHAIN FREE • ALLOCATED PARKING BAY • WALKING DISTANCE TO ORPINGTON STATION • SECLUDED 40FT GARDEN • 19FT RECEPTION • DOUBLE BEDROOM & WALK-IN WARDROBE • FITTED KITCHEN • AMPLE STORAGE • DOUBLE GLAZING & GAS CENTRAL HEATING • WALKING DISTANCE TO ORPINGTON HIGH STREET

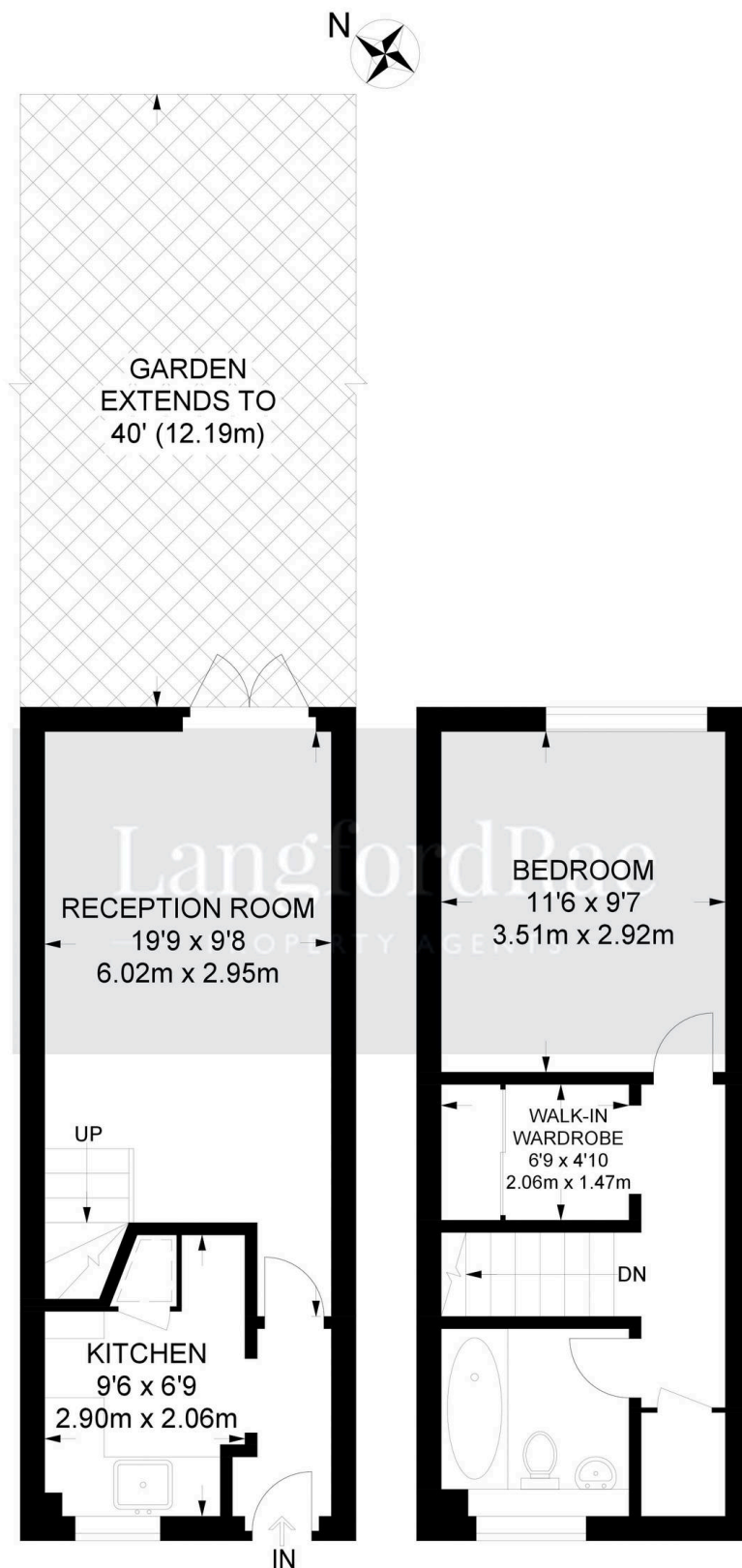



GROUND FLOOR
256 SQ FT / 23.8 SQ M

FIRST FLOOR
254 SQ FT / 23.6 SQ M

APPROXIMATE GROSS INTERNAL AREA
510 SQ FT / 47.4 SQ M

You can include any text here. The text can be modified upon generating your brochure.