

## 11 Oxenden Wood Road, Orpington

£1,600,000 Freehold

CHAIN FREE • 37FT OPEN PLAN FAMILY LIVING • 34FT ANNEX/THERAPY ROOM/GYM • STEAM ROOM • POTENTIAL TO EXTEND (STPP) • ENSUITE TO MASTER • CLOAKROOM & FAMILY BATHROOM • SWIMMING POOL & GARDEN OFFICE • EXTENSIVE GARDENS AND GARAGES • WALKING DISTANCE TO CHELSFIELD STATION

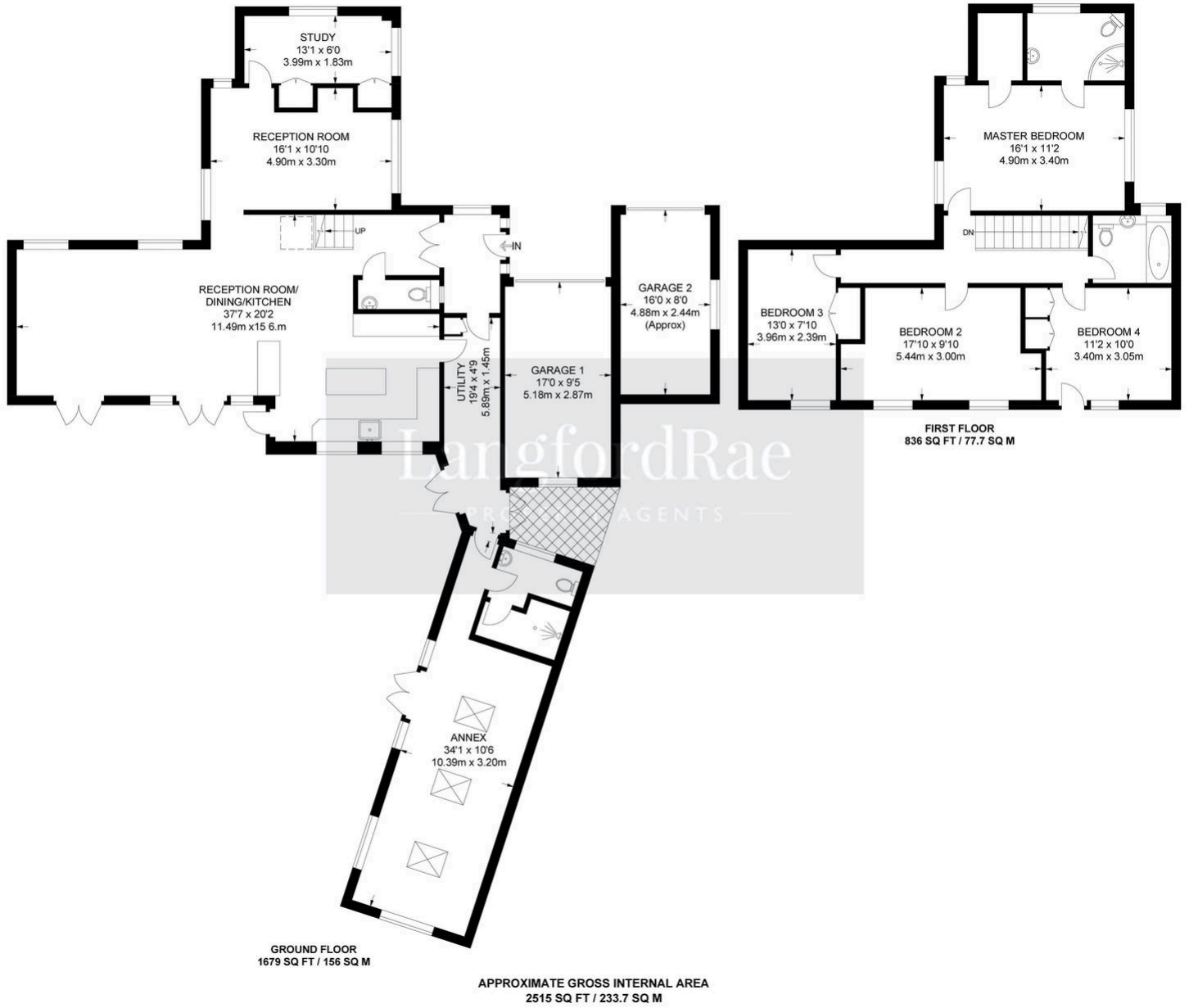



You can include any text here. The text can be modified upon generating your brochure.