



30 Warnford Road, Orpington

£775,000 Freehold

CLOSE TO WARREN ROAD SCHOOL • SOUTH FACING GARDEN • DRIVEWAY FOR TWO CARS • 21FT KITCHEN/DINER • UTILITY • TWO RECEPTION ROOMS • ENSUITE TO MASTER • GUEST BEDROOM & SHOWER ROOM • FAMILY BATHROOM • CLOST TO MULTIPLE STATIONS



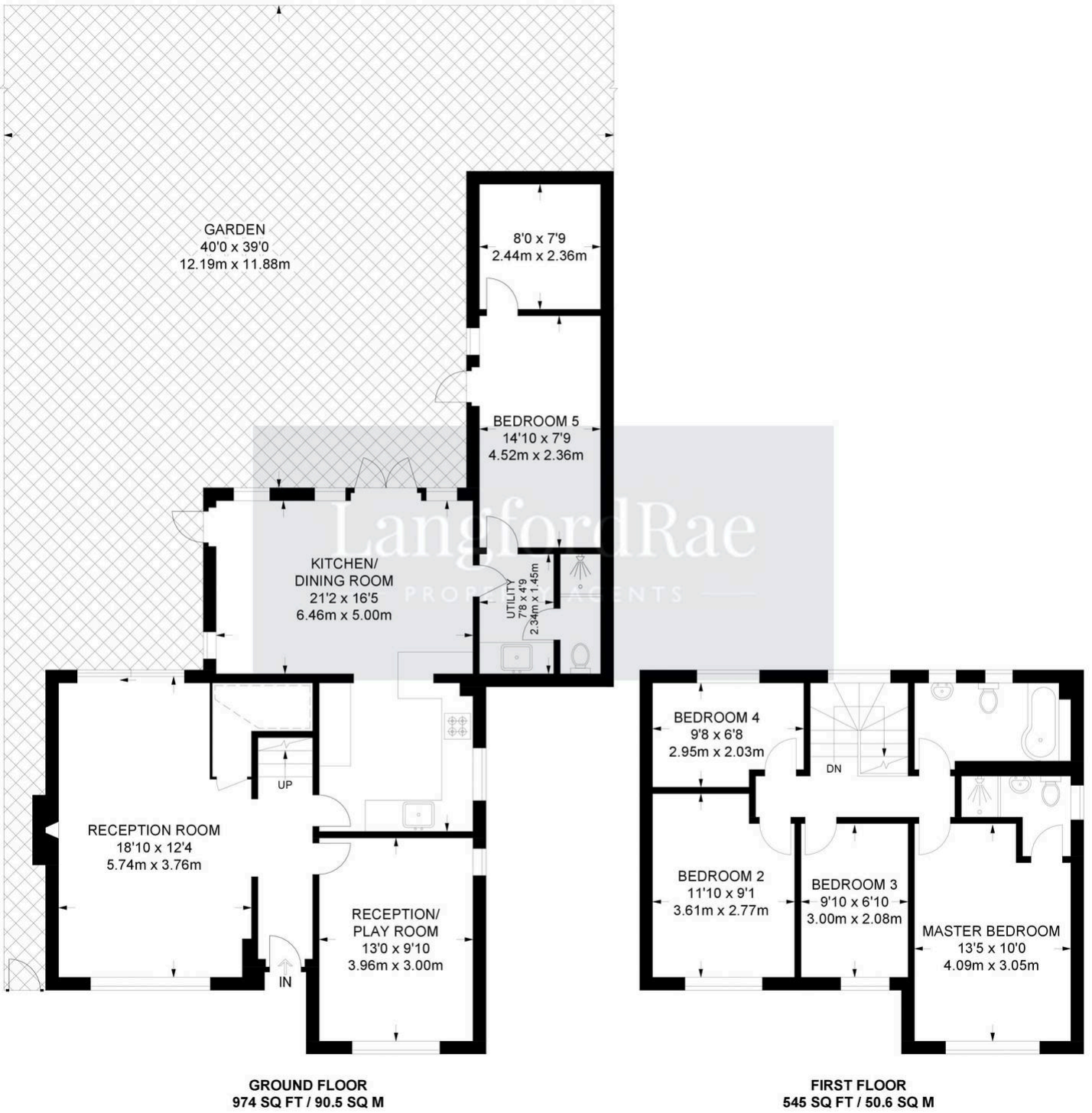

GROUND FLOOR
974 SQ FT / 90.5 SQ M

FIRST FLOOR
545 SQ FT / 50.6 SQ M

APPROXIMATE GROSS INTERNAL AREA
1519 SQ FT / 141.1 SQ M

You can include any text here. The text can be modified upon generating your brochure.