



61 Stowe Road, Orpington

£600,000 Freehold

EXTENDED KITCHEN/DINER • 24FT RECEPTION • STUDY • FAMILY BATHROOM • RECENTLY FITTED BOILER • AMPLE STORAGE • 84FT SECLUDED REAR GARDEN • CLOSE TO LOCAL SCHOOLS & AMENITIES • WALKING DISTANCE TO CHELSFIELD STATION



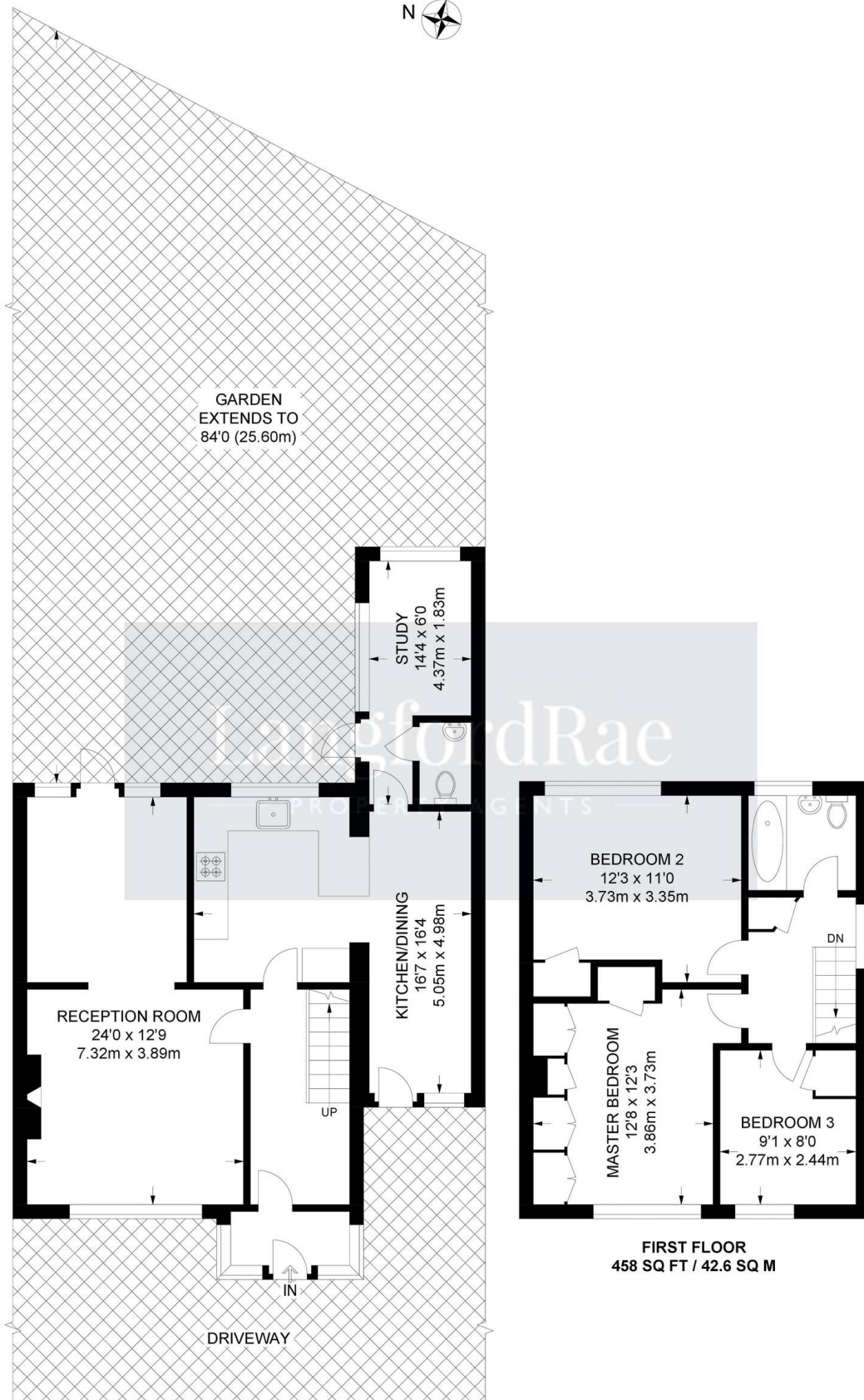

GROUND FLOOR
689 SQ FT / 64 SQ M

FIRST FLOOR
458 SQ FT / 42.6 SQ M

APPROXIMATE GROSS INTERNAL AREA
1147 SQ FT / 106.6 SQ M

You can include any text here. The text can be modified upon generating your brochure.